

DNC Series ISO6431 Standard Cylinder

DNC-50×100

MDNC-50×100

TDNC-50×100

Ordering Code

□ — **DNC** — **63** × **50** — **25** — **S** — □

Tube Type Blank: Square Type T: Tie-rod Type M: Mickey Mouse Type	Series Code DNC: ISO6431 Standard Double Action Type DNCD: ISO6431 Standard Two Axis Double Action Type DNCJ: ISO6431 Two Axis Stroke Adjust Type	Cylinder Bore 32mm-125mm	Stroke	Adjust Stroke 25: 25mm 50: 50mm 75: 75mm	Magnet Code Blank: Without Magnet S: With Magnet	Fixed Type Blank: Normal type LB: Front and back fixed type FA: Front cover fixed type (Front flange type) FB: Back cover fixed type (Back flange type) CA: Back cover fixed type (Single Earring) CB: Back cover fixed type (Double Earring) SDB: Back cover fixed type
---	--	------------------------------------	---------------	--	---	--

Internal structure

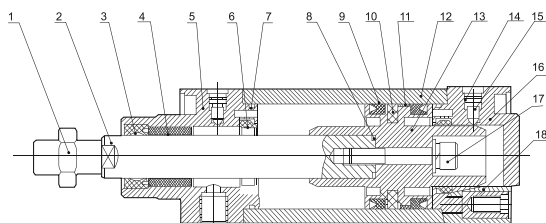

NO	Designation	NO	Designation
1	Piston Rod Nut	2	Piston Rod
3	Front Cover Seal Ring	4	Bearing
5	Front Cover	6	Buffering O-Ring
7	O-Ring	8	Piston rod O-Ring
9	Piston O-Ring	10	Magnet (Optional)
11	Wear Ring	12	Barrel
13	Piston	14	Cushion Seal
15	Cushion Needle	16	Back Cover
17	Hex Socket Screw	18	Profile Bolt

Specification

Bore(mm)	32	40	50	63	80	100	125
Motion Pattern	Filtered Air						
Working Medium	Double Action						
Compression Pressure	1.5MPa						
Max. Operating Pressure	1.0MPa						
Min. Operating Pressure	0.1MPa						
Buffer	Air Buffer (Standard)						
Condition Temperature	-5~70°C						
Operating Speed	50~800mm/s						
Port Size	G1/8"	G1/4"	G3/8"	G1/2"			

Stroke

Bore	Standard Stroke	Buffer Stroke	Stroke Range
32			
40		20	
50	25 40 50 80		
63	100 125 160	22	10~2000
80	200 250 320		
100	400 500	32	
125		35	

DNC Series ISO6431 Standard Cylinder

Overall Dimensions

Normal Type
DNC-S

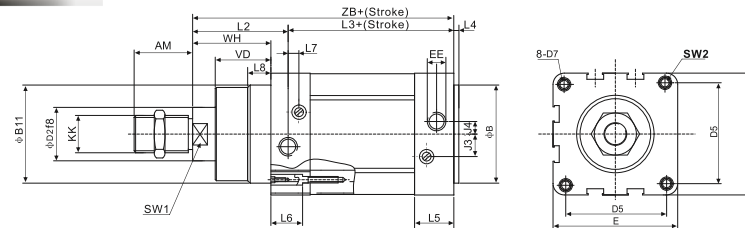

Dimension Sheet

Bore	AM	B	D2	D5	D7	E	EE(G)	J3	J4	KK	L2	L3	L4	L5	L6	L7	L8	SW1	SW2	VD	WH
32	22	30	12	32.5	M6	45	1/8	6	5.2	M10×1.25	41.6	62.8	4	26	16	3.3	10	10	6	12	26
40	24	35	16	38	M6	54	1/4	8	6	M12×1.25	44	77	4	29.6	16	3.6	10.5	13	6	20	30
50	32	40	20	46.5	M8	64	1/4	10	8.5	M16×1.5	51	78	4	30	17	5.1	11.5	17	8	27	37
63	32	45	20	56.5	M8	75	3/8	12.4	10	M16×1.5	54	87	4	35.6	17	6.6	15	17	8	27	37
80	40	45	25	72	M10	93	3/8	12.5	8	M20×1.5	62.4	95.2	4	35.9	17	10.5	15.7	22	10	34.7	46
100	40	55	25	89	M10	110	1/2	11.8	10	M20×1.5	69.8	100.4	4	39	17	8	19.2	22	10	38	51
125	54	60	32	110	M12	134	1/2	13	8	M27×2	83	124	6	44.7	22	14	20.5	28	12	46	65

Overall Dimensions

Double Piston Rod Type
DNC-D-S

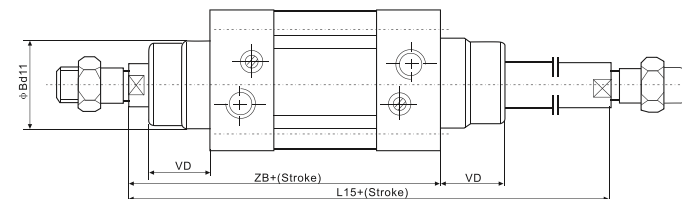

Dimension Sheet

Bore	32	40	50	63	80	100
B	30	35	40	45	45	55
L15	46	165	180	195	220	240
VD	16	20	27	27	34.7	38.2
ZB	120	135	143	158	174	189

DNCB Series Booster Cylinder

Specification

Motion Pattern	Filtered Air
Compression Pressure	1.5MPa
Max. Operating Pressure	1.0MPa
Min. Operating Pressure	0.1MPa
Condition Temperature	-5~70°C

Product instruction

Booster cylinder combine 2 or more ISO15552 standard cylinder with the same bore and stroke. Create twice or multiple force as standard cylinder. The connection of 2 or more cylinders are linked with the same material Compact structure and easy for installation.

DNCB-50×25×50